

LG Product Installation



TWIN WASH™
SYSTEM

Washer

Pedestal Washer

LG Product Installation

- Twin Wash (Pedestal Washer)

DON'T place product upside down



DON'T lay down on side wall

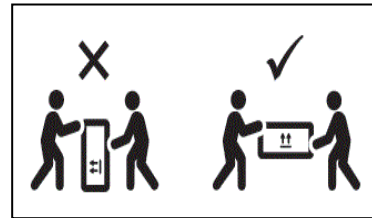
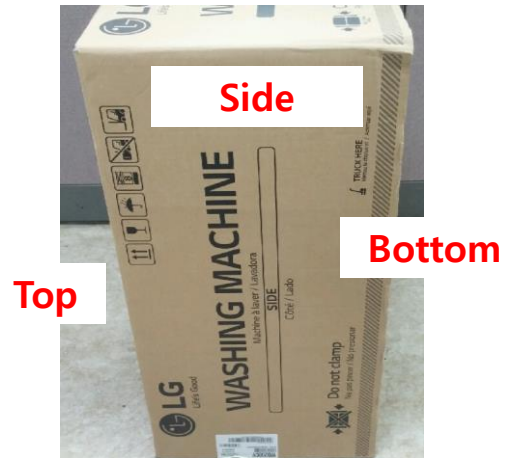

- Sliding door damage (some models)
- Inner Tub assembly damage



- Drawer damage
- Control panel damage

LG Product Installation

- Twin Wash (Pedestal Washer)



- ① Remove packing material (foam)
- ② Rotate cover 180° and secure with provided screws

→ Remove blue inner packing from Tub and discard

To prevent scratches, PRIOR to installing the FLW:



→ Remove blue tape

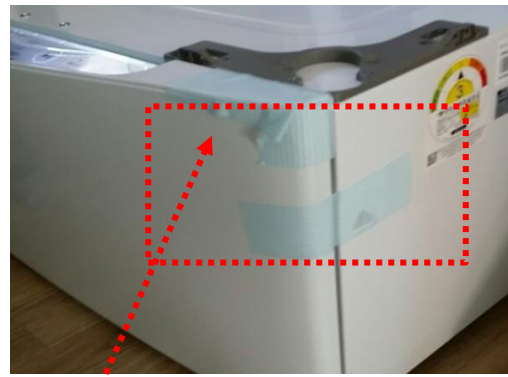

→ Adhere tape to the edges and drawer to prevent scratches or the drawer opening.

LG Product Installation

- Twin Wash (Pedestal Washer)- Installing the Front Load Washer



→ Using the wrench provided make sure the legs of the FLW are fully retracted and level prior to mounting



→ Align and set down the main washer to the holes at each corner of the unit.
→ Make sure actuator of washer sits on correct position, depressing the contact on the Sidekick

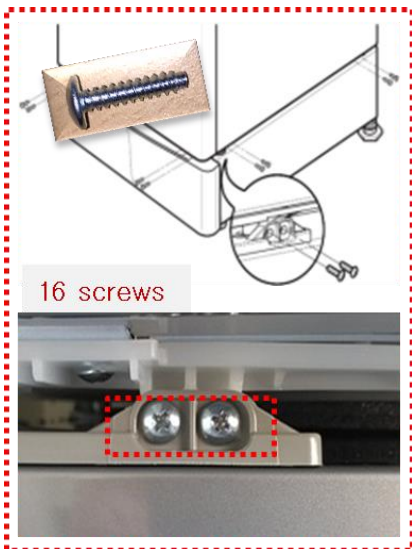

→ Secure FLW to Sidekick with 16 screws provided. Not using all screws can cause noise and vibration issues.

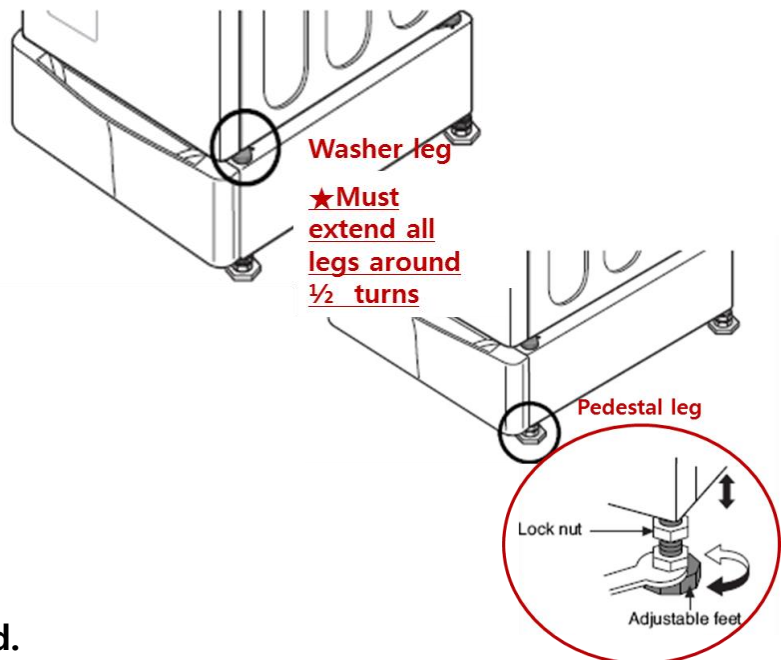

→ Adjust the legs of the flw and Sidekick.
→ Then adjust the lock nuts toward the washer and pedestal

LG Product Installation

- Twin Wash (Pedestal Washer) – Water Hook Up



→ Remove film from lid

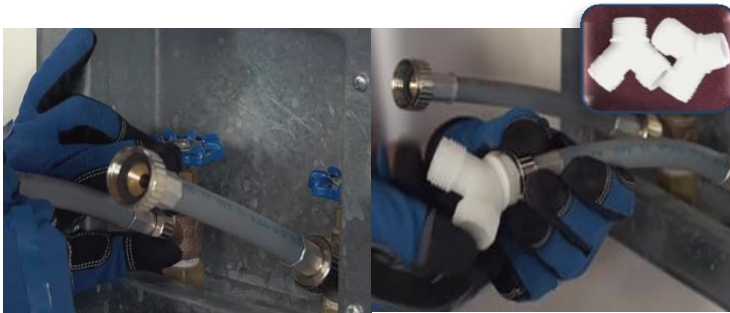

→ Attach 2 short hoses included in the Installation kit to the faucets.
Red for Hot / **Blue** for Cold

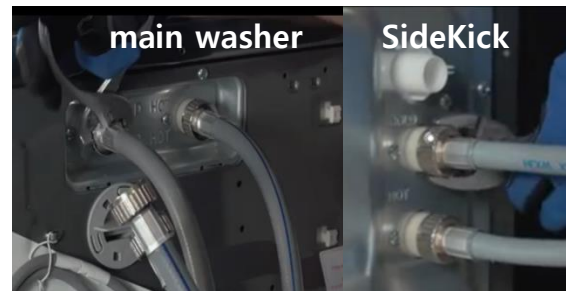

→ Connect the long hoses to the back of the main washer
→ Then connect the other 2 hoses to the back of the SideKick



→ Connect main wash hoses to Y connector.
→ Connect SideKick hoses to the other side of the Y connectors.
→ Once all hoses connected make sure they are all tighten

LG Product Installation

- Twin Wash (Pedestal Washer)

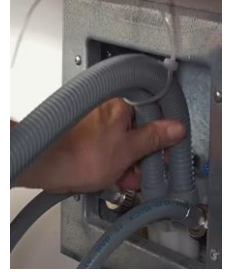
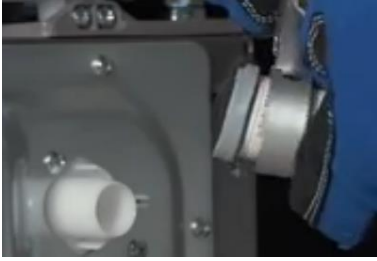

- Place wide clamp supplied with installation kit around end of Drain Hose.
- Connect drain hose to SideKick making sure it points up

- Connect drain hoses to Y drain hose connector. Use clamps provided to secure them.
- The end of the Y drain hose connector is then inserted in the stand pipe



- Secure hoses together with supplied tie straps



Failure to use the clamps could result in flooding in the hoses come loose from the Y-connector.

- Turn water on and check all connections.
- Place unit in final position.
- Level units

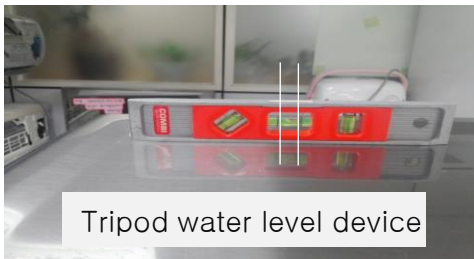

Tripod water level device

