

COMBINATION INSTALLATIONS



DMT2420 or DMW2420 Microwave/ DTO Wall Oven/Warming Drawer

PLANNING GUIDE

All tolerances: $\pm 1/16"$ (± 1.6 mm), unless otherwise stated.

WARNING

- Observe all governing codes and ordinances during planning and installation. Contact your local building department for further information.
- All appliances must be installed in accordance with the accompanying installation instructions.

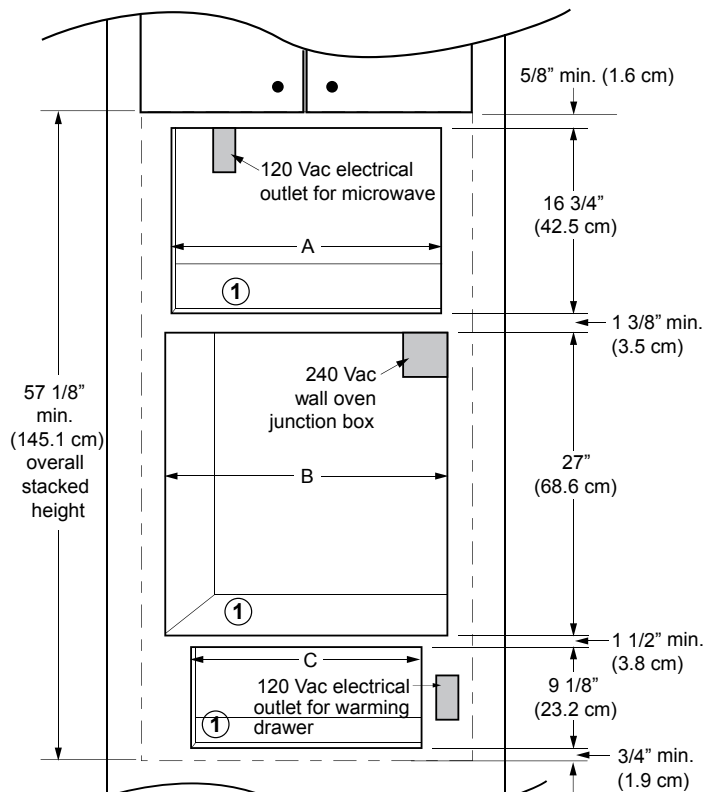

**CUTOUT DIMENSIONS
WITH ADMWTK MICROWAVE TRIM KIT**

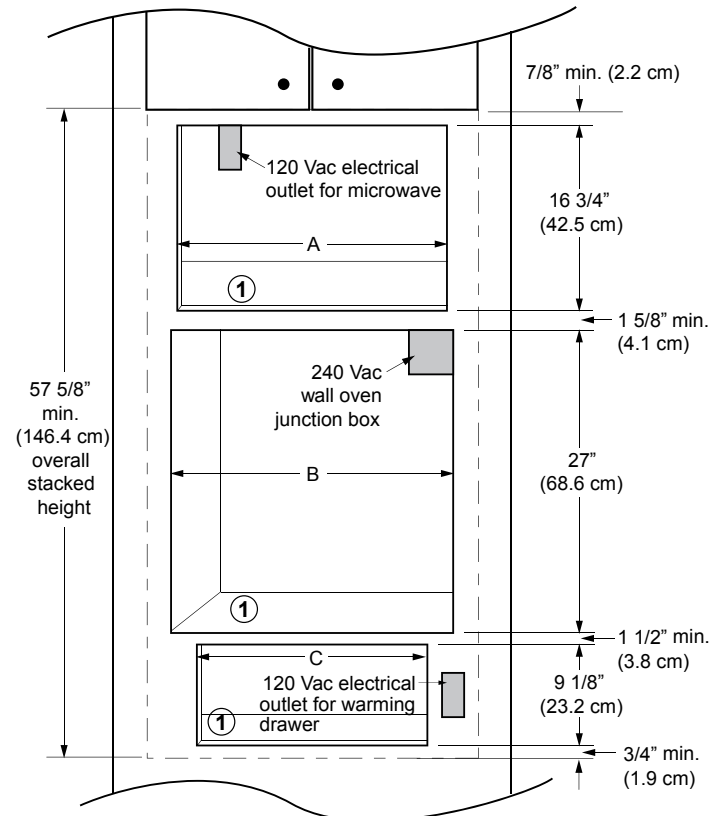

**CUTOUT DIMENSIONS
WITH AOMTK MICROWAVE TRIM KIT**

NOTE:

1. $3/4"$ (1.9 cm) support platform (flush with cutout).
2. See individual appliance Planning Guide pages to determine overlays.
3. Spacing between appliances and drawers/doors shown is minimum required to allow for ventilation and prevent scraping. Additional space may need to be added for appearance.
4. Warming drawer model OWD24 is not approved for installation above, below or adjacent to a wall oven or another warming drawer (any type).

DMT2420 or DMW2420 Microwave Trim Kit	(A) Cutout Width
ADMWTK271*	25 3/4" (65.4 cm)
ADMWTK301*	28 1/4" (71.8 cm)
AOMTK27	24 3/8" (61.9 cm)
AOMTK30	25 1/4" (64.1 cm)

* Available only in stainless steel. Matches DMW2420 only.

Wall Oven Models	(B) Cutout Width
Single 27"	25 1/2" (64.8 cm)
Single 30"	28 1/2" (72.4 cm)

Warming Drawer Models	(C) Cutout Width
27"	25 1/2" (64.8 cm)
30"	28 1/2" (72.4 cm)