

SUMMIT



FROST-FREE REFRIGERATOR-FREEZER

**Models FF1118W series
FF1119B series
FF1159SS series**



Owner's Manual

**BEFORE USE, PLEASE READ AND FOLLOW
ALL SAFETY RULES AND OPERATING INSTRUCTIONS**

Write the Model and Serial Numbers here:

Model: _____

Ser. No.: _____

FELIX STORCH, INC.
770 Garrison Avenue
Bronx, NY 10474
www.summitappliance.com

IMPORTANT SAFEGUARDS

Your safety and the safety of others are very important.

We have provided many important safety messages in this manual and on your appliance. Always read and obey all safety messages.



This is the Safety Alert Symbol. This symbol alerts you to potential hazards that can kill or injure you and others. All safety messages will follow the Safety Alert Symbol and either the word "DANGER" or "WARNING".



DANGER means that failure to heed this safety statement may result in severe personal injury or death.



WARNING means that failure to heed this safety statement may result in extensive product damage, serious personal injury, or death.

Safety messages will alert you to what the potential hazard is, tell you how to reduce the chance of injury, and let you know what can happen if the instructions are not followed.



Before the refrigerator is used, it must be properly positioned and installed as described in this manual, so read the manual carefully. To reduce the risk of fire, electrical shock or injury when using the refrigerator, follow basic precautions, including the following:



- Plug into a grounded 3-prong outlet. Do not remove grounding prong, do not use an adapter, and do not use an extension cord.
- It is recommended that a separate circuit, serving only your refrigerator, be provided. Use receptacles that cannot be turned off by a switch or pull chain.
- Never clean refrigerator parts with flammable fluids. These fumes can create a fire hazard or explosion. And do not store or use gasoline or other flammable vapors and liquids in the vicinity of this or any other appliance. The fumes can create a fire hazard or explosion.
- Do not connect or disconnect the electric plug when your hands are wet.
- Unplug the refrigerator or disconnect the power before cleaning or servicing. Failure to do so can result in electrical shock or death.
- Do not attempt to repair or replace any part of your refrigerator unless it is specifically recommended in this material. All other servicing should be referred to a qualified technician.



WARNING

- **This unit is not designed to operate in enclosed spaces. When placing your unit, make sure you allow adequate airflow on all sides.**
 - Use two or more people to move and install the refrigerator. Failure to do so can result in back or other injury.
 - To ensure proper ventilation for your refrigerator, the front of the unit must be completely unobstructed. Choose a well-ventilated area with temperatures above 60°F (16°C) and below 90°F (32°C). This unit must be installed in an area protected from the elements, such as wind, rain, water spray or drips.
 - The refrigerator should not be located next to ovens, grills or other sources of high heat.
 - The refrigerator must be installed with all electrical connections in accordance with state and local codes. A standard electrical supply (115V AC only, 60 Hz), properly grounded in accordance with the National Electrical Code and local codes and ordinances, is required.
 - Do not kink or pinch the power supply cord of the refrigerator.
 - The fuse (or circuit breaker) size should be 15 amperes.
 - It is important for the refrigerator to be leveled in order to work properly. You may need to make several adjustments to level it.
 - Do not use solvent-based cleaning agents or abrasives on the interior. These cleaners may damage or discolor the interior.
 - Do not use this apparatus for other than its intended purpose.
-



DANGER



Risk of child entrapment

Child entrapment and suffocation are not problems of the past. Junked or abandoned refrigerators are still dangerous, even if they will “just sit in the garage a few days.”

- **Before you throw away your old refrigerator:** Take off the doors. Leave the shelves in place so that children may not easily climb inside.
- Never allow children to operate, play with, or crawl inside the refrigerator.

- SAVE THESE INSTRUCTIONS -

Table of Contents

Important Safeguards 1 - 2

Location of Parts 3

Technical Information 4

Installation Instructions 4 - 7

Before Using Your Appliance 4

Installing the Appliance 4 - 5

Electrical Connection / Extension Cord 5

Reversing the Door Swing 6 - 7

Operating Your Refrigerator 8 - 9

Setting the Temperature Controls 8

Frost-Free Defrost System 8 - 9

Making Ice Cubes / Hot-Line 9

Care and Maintenance 10 - 11

Cleaning Your Refrigerator / Evaporation Tray / Power Failure / Vacation Time 10

Moving your Unit / Energy-Saving Tips 11

Troubleshooting 12

Limited Warranty 13

Location of Parts

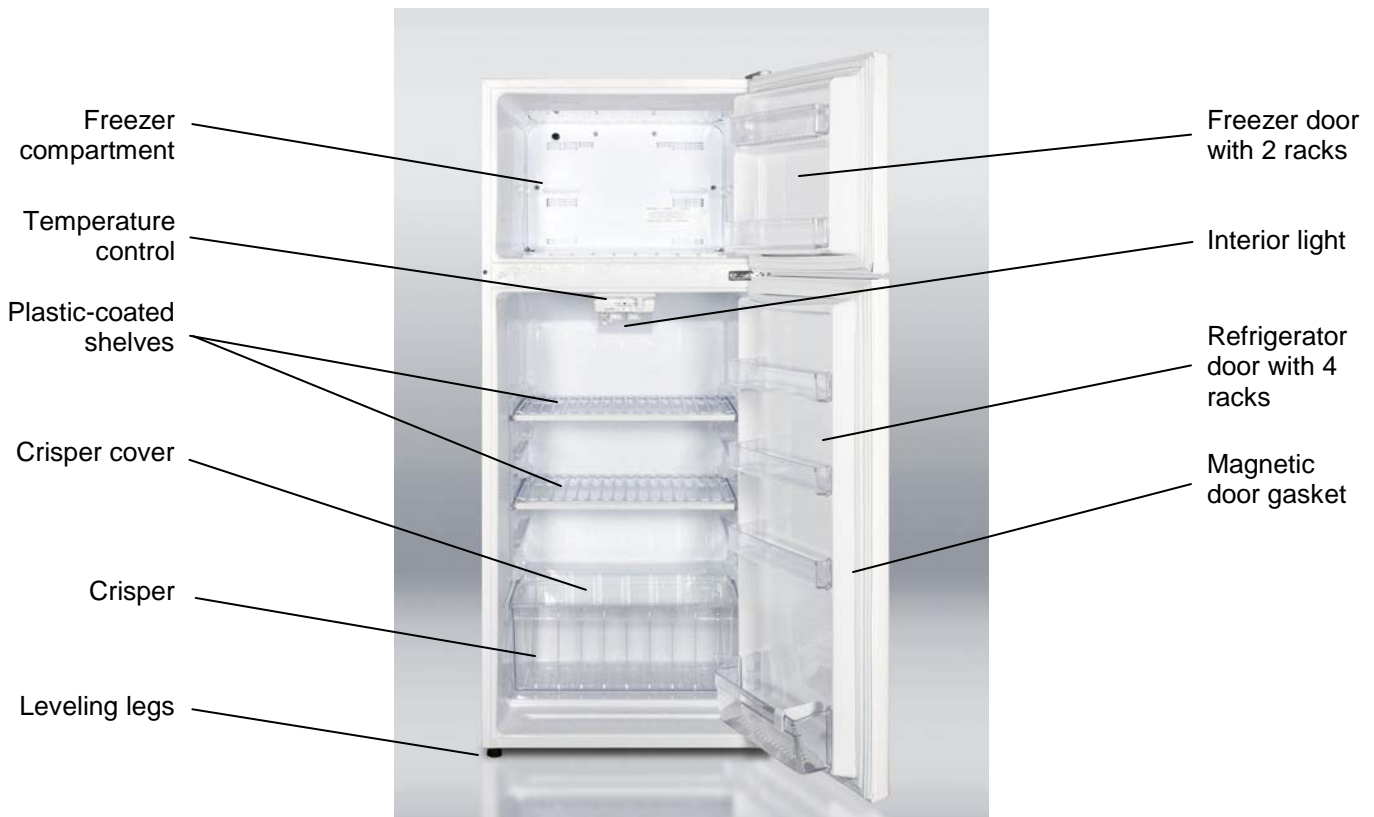

Technical Information

Models:	FF1118W (white) FF1119B (black) FF1159SS (black cabinet with stainless steel doors)
Capacity:	10.3 cubic feet
Electrical Input:	115V AC / 60Hz
Rated Current:	1.6A
Energy Consumption:	297 kWh/yr
Energy Star approved:	Yes
Refrigerant:	R134a, 5.3 oz
Installation:	Free-standing
Shipping Weight:	166 lbs
Unit Dimensions:	23.63"W x 26.0"D x 58.88"H

Installation Instructions

Before Using Your Appliance:

- Remove the exterior and interior packing.
- Check to be sure you have all of the following parts:
 - 2 wire shelves
 - 1 crisper drawer with clear cover
 - 1 ice cube tray
- Before connecting the unit to the power source, let it stand for approximately 2 hours. This will reduce the possibility of a malfunction in the cooling system from handling during transportation.
- Clean the interior surface with lukewarm water using a soft cloth.

Installing the Appliance:

- This appliance is designed to be free-standing only, and should not be recessed or built in.
- Place your unit on a floor that is strong enough to support it when it is fully loaded. To level your unit, adjust the leveling legs at the bottom.
- Allow 5 inches of space between the back and sides of the unit, which will allow the proper air circulation to cool the compressor and condenser.
- Locate the unit away from direct sunlight and sources of heat (stove, heater, radiator, etc.). Direct sunlight may affect the acrylic coating and heat sources

may increase electrical consumption. Extremely cold ambient temperatures may also affect the unit's performance.

- Avoid locating the unit in moist areas.
- Plug the unit into an exclusive, properly installed and grounded wall outlet. Do not under any circumstances cut or remove the third (ground) prong from the power cord. Any questions concerning power and/or grounding should be directed toward a certified electrician or authorized service center.
- After plugging the appliance into a wall outlet, allow the unit to cool down for 2 to 3 hours before placing food inside.

Electrical Connection:

WARNING

Improper use of the grounded plug can result in the risk of electrical shock. If the power cord is damaged, have it replaced by an authorized service center.

This unit should be properly grounded for your safety. The power cord of this unit is equipped with a three-prong plug which mates with a standard three-prong wall outlet to minimize the possibility of electrical shock.

Do not under any circumstances cut or remove the third ground prong from the power cord supplied. For personal safety, this appliance must be properly grounded.

This unit requires a standard 115-volt AC/60Hz electrical outlet with three-prong ground. Have the wall outlet and circuit checked by a qualified electrician to make sure the outlet is properly grounded. When a standard 2-prong wall outlet is encountered, it is your responsibility and obligation to have it replaced with a properly grounded 3-prong wall outlet.

To prevent accidental injury, the cord should be secured behind the unit and not left exposed or dangling.

The unit should always be plugged into its own individual electrical outlet which has a voltage rating that matches the rating label on the appliance. This provides the best performance and also prevents overloading house wiring circuits that could cause a fire hazard from overheated wires. Never unplug the unit by pulling on the power cord. Always grip the plug firmly and pull straight out from the receptacle. Repair or replace immediately any power cord that has become frayed or otherwise damaged. Do not use a cord that shows cracks or abrasion damage along its length or at either end. When moving the unit, be careful not to damage the power cord.

Extension Cord:

Do not use an extension cord with this appliance. If the power cord is too short, have a qualified electrician or service technician install an outlet near the appliance.

Reversing the Door Swing:

The doors of the refrigerator-freezer can be hinged on either side so that the door swing can be suited to the location of the installation.

Tools Required:

- standard screwdriver
- large Phillips head screwdriver
- socket wrench (3/8")

In order to reverse the position of the door hinges, refer to the disassembly diagram below and follow this procedure.

1. Remove the hinge cap by twisting it off.
2. Remove the upper hexagonal-head screws. The top hinge and the freezer door can now be removed.
3. Remove the middle hexagonal screws. The middle hinge and the refrigerator door can now be removed.
4. Remove the cover and screws for the middle hinge holes on the left side and re-attach them symmetrically to the holes on the other side.

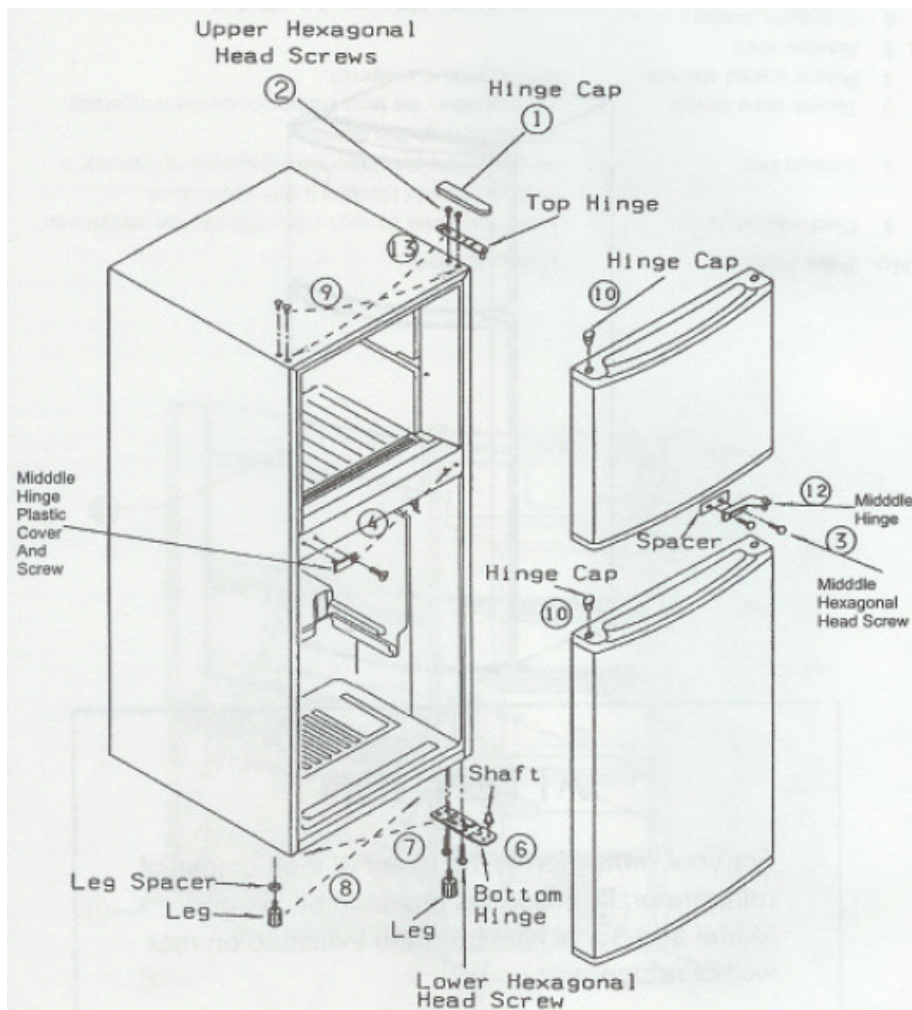

5. Tilt the refrigerator back or lay it on its back for steps 6, 7 and 8. Use a pad or blanket to protect the floor and to avoid scratching the painted finish.
6. Remove the leveling legs by turning them counterclockwise. Remove the lower hexagonal-head screws, two on the hinge side and one near the front corner of the other side.
7. Attach the bottom hinge symmetrically to the other side of the cabinet with the screws removed in Step 6. (Do not tighten screws completely.)
8. Attach the left side leg and the leg spacer to the other side hole which was positioned symmetrically.
9. Stand the unit back in the upright position.
10. Remove the upper hinge plastic pins and insert them in the holes from which the screws were removed in Step 2.
11. Take off the hinge collar caps from both the freezer and refrigerator doors using a screwdriver and insert them in the hinge collars on the opposite side.
12. Attach the shaft to the hinge bottom. Attach the refrigerator door to the shaft.
13. Rotate the middle hinge 180°. Attach it to the refrigerator door and secure it with screws. (Do not tighten screws completely.)
14. Attach the upper hinge to the freezer door. Attach the freezer door to the middle hinge and use the screws to attach the upper hinge. (Do not tighten screws completely.)
15. The direction in which the doors open has now been changed; however, the following points should be checked:
 - a. Make sure the doors are on straight.
 - b. Make sure there is no space between the door gaskets and the refrigerator and freezer units themselves when the doors are closed.
 - c. Make sure that the gasket on the hinge side is not caught between the door and the unit when the door is opened or closed. (If the door is forced closed when the gasket is caught, the gasket might be damaged.)
 - d. When checking the above points, if it is discovered that the doors are not installed properly (this is apt to happen on the first try), loosen the screws holding the upper hinge, straighten the door and tighten the screws slowly with the socket wrench. After making sure that the doors are installed correctly, tighten all the screws holding the hinge.
If they are not tightened, the doors may slip out of position or there may be an opening between the doors and the unit.

Operating Your Refrigerator

Setting the Temperature Controls:

Your unit has one control for regulating the temperature in the refrigerator compartment and a separate one for the freezer.

Refrigerator:

The refrigerator compartment's temperature control (thermostat) is a dial type located at the top center of the compartment.

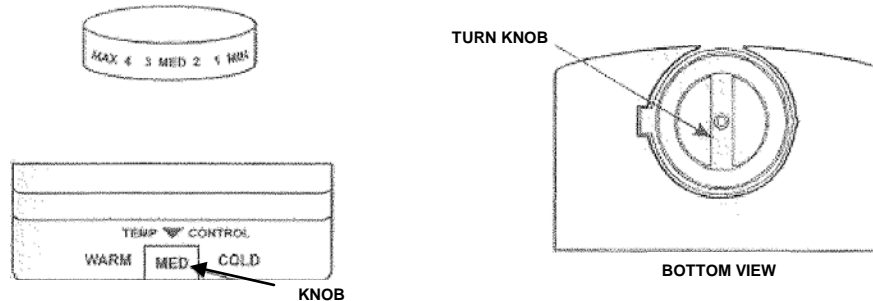

- When you turn the unit on for the first time, set the control to its coldest setting, which is **MAX**.
- After several hours, adjust the temperature control to the setting that best suits your needs. The setting **MED** should be appropriate for most uses.

Freezer:

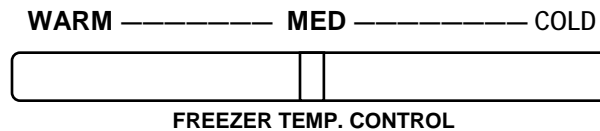

The temperature control for the freezer is a slide switch located on the back wall of the compartment. It has settings of **WARM**, **MED** and **COLD**. When first turning on the unit, set this switch to **COLD**, then after a few hours, slide it back to **MED**.

NOTES:

1. To completely turn off the unit, disconnect the power.
2. If the unit is unplugged, has lost power, or is turned off, you must wait 3 to 5 minutes before restarting it. If you attempt to restart before this time delay, the unit will not start.

Frost-Free Defrost System:

It is not necessary for you to defrost either the refrigerator or the freezer compartment of this appliance. While the compressor is operating, ice may build up along the cold rear wall of the refrigerator compartment (the evaporator is

behind the wall). During the compressor's off-cycle, the ice will melt, drip down, and drain through a small hole behind the crisper into a tray above the compressor where the compressor's heat evaporates the water.

If you notice an excessive build-up of ice on the rear wall of either the refrigerator or the freezer compartment, try setting the thermostat to a slightly warmer setting. Be sure the door gasket is well seated. Occasionally you should check that there is no obstruction of the drain hole in the bottom rear of the refrigerator cabinet.

Making Ice Cubes:

In the freezer compartment, high-quality ice cubes are formed in about 3 hours. Once the cubes have been formed, they can be removed from the ice tray by twisting it gently.

NOTES:

1. Since water expands when it freezes, do not fill the ice tray above the level of the separation dividers.
2. When using a receptacle other than the supplied ice cube tray to make a large quantity of ice, you may find that the temperature in the freezer will rise. This can cause ice cream and other such items to soften temporarily.
3. When ice cubes are stored for an extended period of time, they may become smaller and stick together.
4. Ice will sometimes develop an off flavor or color if kept too long. To avoid this, empty the ice tray and make a completely new batch about once a month.

Hot-Line:

With the refrigerator-freezer in operation, it is possible that the housing will feel warm at the front edges. This does not indicate trouble. It is attributable to the hot-line design adopted for this refrigerator-freezer which consists of piping hot gas from the motor-driven compressor along the front edges of the housing and the center partition to prevent moisture from accumulating. This has nothing to do with the storage temperature inside.

In the illustration, the dark line indicates the hot-line.

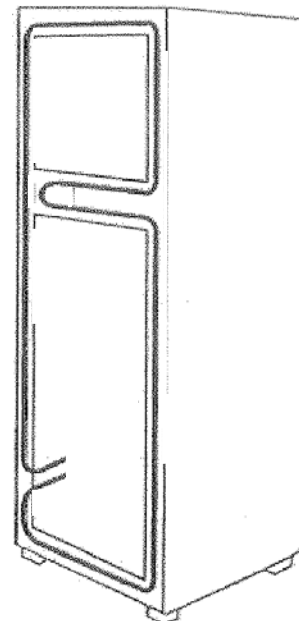

Care and Maintenance

Cleaning Your Refrigerator:

1. Unplug the unit and remove the food, shelves and crisper.
2. Wash the inside surfaces with a solution of warm water and baking soda. The solution should contain about 2 tablespoons of baking soda to a quart of water. Rinse and dry thoroughly with a clean soft cloth.
3. Wash the shelves and crisper with a mild detergent solution. Rinse and dry.
4. Wash the outside cabinet with warm water and mild liquid detergent. Rinse well and wipe dry with a clean soft cloth.
5. Wring excess water out of the sponge or cloth before cleaning the area of the controls, or any electrical parts.

CAUTION: Failure to unplug the unit could result in electrical shock or personal injury. Never use acids, chemical thinners, gasoline, benzene or hot water for cleaning any part of the refrigerator-freezer. Also avoid any harsh cleansers or abrasive cloths or cleaning pads.

Cleaning the Evaporation Tray:

The evaporation tray is set at the back of the refrigerator-freezer, just above the compressor. Since dust and grime accumulating on this tray will decrease the evaporation efficiency, it should be cleaned every six months or so.

To remove the evaporation tray, unscrew it and slide it out. Clean it as you would any other plastic part. Once the tray is clean, reposition it over the compressor, making sure that it is level and attached properly.

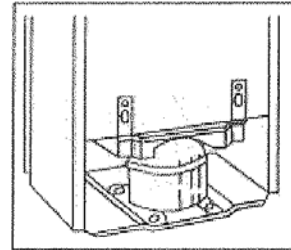

Power Failure:

Most power failures are corrected within a few hours and should not affect the temperature of your unit if you minimize the number of times the doors are opened. If the power is going to be off for a longer period of time, you need to take the proper steps to protect your food.

Vacation Time:

Short vacations: Leave the appliance operating during vacations of less than three weeks.

Long vacations: If the unit will not be used for several months, remove all food and unplug the power cord. Clean and dry the interior thoroughly. To prevent odor and mold growth, leave the doors open slightly, blocking them open if necessary.

Moving Your Unit:

1. Remove all the food.
2. Securely tape down all loose items inside your unit.
3. Turn the leveling legs up to the base to avoid damage.
4. Tape the doors shut.
5. Be sure the unit stays secure in the upright position during transportation. Also, protect the outside of the unit with a blanket or similar covering.

Energy-Saving Tips:

- The unit should be located in the coolest area of the room, away from heat-producing appliances and out of direct sunlight.
- Let hot foods cool to room temperature before placing in the unit. Overloading the unit forces the compressor to run longer.
- Be sure to wrap foods properly and wipe containers dry before placing them in the unit. This cuts down on frost build-up inside the unit.
- The unit's storage area should not be lined with aluminum foil, wax paper or paper toweling. Liners interfere with cold air circulation, making the unit less efficient.
- Organize and label food to reduce door openings and extended searches. Remove as many items as needed at one time, and close the door as soon as possible.

Troubleshooting

You can easily solve many common problems with your appliance, saving you the cost of a possible service call. Try the suggestions below to see if you can correct the problem before calling the service provider.

TROUBLESHOOTING GUIDE

Problem	Possible Cause
Unit does not operate.	Not plugged in. The circuit breaker has tripped or the fuse has blown.
Turns on and off frequently.	Room temperature is warmer than usual. A large amount of food has been added to the unit. The doors are opened too often. The doors are not closed completely. Temperature control is not set correctly. The door gaskets do not seal properly. The unit does not have the correct clearances.
Vibrations	Check to be sure the unit is level.
The unit seems to be making too much noise.	A rattling noise may come from the flow of refrigerant, which is normal. As each cycle ends, you may hear gurgling sounds caused by the flow of refrigerant in your unit. Contraction and expansion of the inside walls may cause popping and crackling noises. The unit is not level.
The doors will not close properly.	The unit is not level. The doors were reversed and not properly re-installed. The gaskets are dirty or bent. The shelves or the crisper are out of position.

Limited Warranty

ONE-YEAR LIMITED WARRANTY

Within the 48 contiguous United States, for one year from the date of purchase, when this appliance is operated and maintained according to instructions attached to or furnished with the product, warrantor will pay for factory-specified parts and repair labor to correct defects in materials or workmanship. Service must be provided by a designated service company. Outside the 48 states, all parts are warranted for one year from manufacturing defects. Plastic parts, shelves and cabinets are warranted to be manufactured to commercially acceptable standards, and are not covered from damage during handling or breakage.

5-YEAR COMPRESSOR WARRANTY

1. The compressor is covered for 5 years.
2. Replacement does not include labor.

ITEMS WARRANTOR WILL NOT PAY FOR:

1. Service calls to correct the installation of your appliance, to instruct you how to use your appliance, to replace or repair fuses or to correct wiring or plumbing.
2. Service calls to repair or replace appliance light bulbs or broken shelves. Consumable parts (such as filters) are excluded from warranty coverage.
3. Damage resulting from accident, alteration, misuse, abuse, fire, flood, acts of God, improper installation, installation not in accordance with electrical or plumbing codes, or use of products not approved by warrantor.
4. Replacement parts or repair labor costs for units operated outside the United States.
5. Repairs to parts or systems resulting from unauthorized modifications made to the appliance.
6. Expenses for travel and transportation for product service in remote locations.
7. The removal and reinstallation of your appliance if it is installed in an inaccessible location or is not installed in accordance with published installation instructions.

DISCLAIMER OF IMPLIED WARRANTIES - LIMITATION OF REMEDIES

CUSTOMER'S SOLE AND EXCLUSIVE REMEDY UNDER THIS LIMITED WARRANTY SHALL BE PRODUCT REPAIR AS PROVIDED HEREIN. IMPLIED WARRANTIES, INCLUDING WARRANTIES OF MERCHANTABILITY OR FITNESS FOR A PARTICULAR PURPOSE, ARE LIMITED TO ONE YEAR. WARRANTOR SHALL NOT BE LIABLE FOR INCIDENTAL OR CONSEQUENTIAL DAMAGES. SOME STATES DO NOT ALLOW THE EXCLUSION OR LIMITATION OF INCIDENTAL OR CONSEQUENTIAL DAMAGES, OR LIMITATIONS ON THE DURATION OF IMPLIED WARRANTIES OF MERCHANTABILITY OR FITNESS, SO THESE EXCLUSIONS OR LIMITATIONS MAY NOT APPLY TO YOU. THIS WARRANTY GIVES YOU SPECIFIC LEGAL RIGHTS AND YOU MAY ALSO HAVE OTHER RIGHTS, WHICH VARY FROM STATE TO STATE.

WARNING! This product may contain chemicals known to the state of California to cause cancer or birth defects or other reproductive harm. For more information, visit: www.summitappliance.com/prop65

Chemicals known by the manufacturer to be present in this product in concentrations higher than threshold limits: NONE.

FELIX STORCH, INC.
770 Garrison Avenue
Bronx, NY 10474
Phone: (718) 893-3900
Fax: (844) 478-8799
www.summitappliance.com

SUMMIT

For parts and accessory ordering,
troubleshooting and helpful hints, visit:
www.summitappliance.com/support