

CVA 7845

Built-in coffee machine with DirectWater

Perfectly combinable design with CoffeeSelect + AutoDescale for highest demands.



- Large touch display with proximity sensor – M Touch + MotionReact
- Individual coffee enjoyment with 3 bean containers – CoffeeSelect
- Perfect care – fully automatic with AutoDescale and AutoClean
- Perfectly positioned: thanks to the patented CupSensor
- 2 coffees at once at the touch of a button – OneTouch for Two

EAN: 4002516426721 / Material number: 11754260 / Old Material Number: 29784510USA

| Construction type and design | |
|---|-----------------|
| Built-in bean-to-cup coffee machine | • |
| VitroLine | • |
| ArtLine | • |
| Color | Brilliant white |
| Consumer benefits | |
| AromaticSystemFresh | • |
| CoffeeSelect | • |
| OneTouch preparation | • |
| One Touch and OneTouch for Two | • |
| DoubleShot | • |
| Programmable User profile | 10 |
| Flavor preserving conical grinding unit | • |
| Grinding grade selectable | • |
| Ground quantity programmable | • |
| Water quantity programmable | • |
| Water temperature programmable | • |
| Amount of milk can be programmed | • |
| Amount of milk froth can be programmed | • |
| Pre-brewing programmable | • |
| TeaTimer | • |
| Control panel | |
| Networking with Miele@home | • |
| Control panel | M Touch |
| MotionReact: light comes on when movement is detected | • |
| MotionReact: display comes on when movement is detected | • |
| CupSensor | • |
| Height adjustment of infinitely adjustable central spout min in in.(cm) | 1 5/8 (4.0) |
| Height adjustment of infinitely adjustable central spout max in in.(cm) | 6 1/2 (16.5) |
| PerformanceMode | • |
| EasyClick milk container | • |
| ComfortDoor | • |
| Hidden door handle | • |
| BrilliantLight | • |
| Brew unit lighting | • |
| Expert mode | • |
| MultiLingua | • |
| MyMiele | • |
| Help function | • |
| No. of bean types | 3 |
| No. of bean containers | 3 |
| Bean container capacity, each in oz (g) | 300 |
| Capacity of bean container B in g | 150 |
| Capacity of bean container C in g | 150 |
| Bean container capacity, total in oz (g) | 21.16 (600) |
| Removable bean container | • |
| Capacity of water container in fl oz (l) | 91.3 (2.7) |
| Milk container capacity in l | 0.7 |

CVA 7845

Built-in coffee machine with DirectWater

Perfectly combinable design with CoffeeSelect + AutoDescal for highest demands.



EAN: 4002516426721 / Material number: 11754260 / Old Material Number: 29784510USA

| | |
|--|------------|
| Drip tray capacity in fl oz (l) | 54.1 (1.6) |
| Easily accessible containers | • |
| Time-of-day display | • |
| Time synchronization | • |
| Date display | • |
| Programmable switch-on time | • |
| Programmable switch-off time | • |
| Programmable stand-by time | • |
| Individual settings | • |
| Beverages | |
| Adjustable beverage portion size in ml | 20-300 |
| Ristretto, single | • |
| Ristretto, double | • |
| Espresso, single | • |
| Espresso, double | • |
| Coffee, single | • |
| Coffee, double | • |
| Long coffee, single | • |
| Long coffee, double | • |
| Cappuccino, single | • |
| Cappuccino, double | • |
| Latte macchiato, single | • |
| Latte macchiato, double | • |
| Hot milk, single | • |
| Latte macchiato, double | • |
| Milk froth, single | • |
| Milk froth, double | • |
| Espresso macchiato, single | • |
| Espresso macchiato, double | • |
| Cappuccino italiano, single | • |
| Cappuccino italiano, double | • |
| Flat white, single | • |
| Flat white, double | • |
| Café au lait, single | • |
| Café au lait, double | • |
| Caffè latte, single | • |
| Caffè latte, double | • |
| Caffè americano, single | • |
| Caffè Americano, double | • |
| Long black, single | • |
| Long black, double | • |
| Allwater | • |
| Warm water, double | • |
| Hot water, single | • |
| Hot water, double | • |
| Black tea, single | • |
| Black tea, double | • |
| Herbal tea, single | • |
| Herbal tea, double | • |
| Fruit tea, single | • |
| Fruit tea, double | • |

CVA 7845

Built-in coffee machine with DirectWater

Perfectly combinable design with CoffeeSelect + AutoDescal for highest demands.

EAN: 4002516426721 / Material number: 11754260 / Old Material Number: 29784510USA

| | |
|---|----------------|
| Green tea, single | • |
| Green tea, double | • |
| White tea, single | • |
| White tea, double | • |
| Japanese tea, single | • |
| Japanese tea, double | • |
| Chai latte, single | • |
| Chai latte, double | • |
| Coffee pot | • |
| Teapot | • |
| Efficiency and sustainability | |
| Energy-saving Eco mode option | • |
| Power rating in standby mode in W | 1.0 |
| Power rating in networked standby in W | 1.4 |
| Time until automatic switch to off mode in min | 20 |
| Time until automatic switch to standby in min | 20 |
| Time until automatic switch to networked standby in min | 20 |
| Cleaning convenience | |
| AutoDescal | • |
| Manual descaling | • |
| AutoClean | • |
| Automatic rinsing of the milk pipework from the water container | • |
| Convenient cleaning programs | • |
| Auto-Off function | • |
| ComfortClean | • |
| Removable milk pipework | • |
| Removable brew unit | • |
| Adjustable water hardness | • |
| Safety | |
| System lock | • |
| Technical data | |
| Niche width min in in.(mm) | 22 1/8 (560) |
| Niche width max in in.(mm) | 22 3/8 (568) |
| Niche height min in in.(mm) | 17 3/4 (450) |
| Niche height max in in.(mm) | 17 7/8 (452) |
| Niche depth in in.(mm) | 21 3/4 (550) |
| Appliance width in in.(mm) | 23 1/2 (595) |
| Appliance height in in.(mm) | 18 (455) |
| Appliance depth in in.(mm) | 18 7/8 (478) |
| Depth with door open in in.(cm) | 42 5/8 (108.0) |
| Total connected load in kW | 1.45 |
| Voltage in V | 120 |
| Fuse rating in A | 15 |
| Number of phases | 1 |
| Length of electrical wire in ft (m) | 6 (2.0) |
| Accessories supplied | |
| Glass milk container | • |
| Descaling cartridge | • |
| AutoCleaner | • |
| Miele coffee 250 gr | • |

CVA 7845

Built-in coffee machine with DirectWater

Perfectly combinable design with CoffeeSelect + AutoDescale for highest demands.



EAN: 4002516426721 / Material number: 11754260 / Old Material Number: 29784510USA

Available display languages

Available display languages via MultiLingua

bahasa malaysia, dansk,
deutsch, eesti, english,
english (AU), english (CA),
english (GB), english (US),
español, français, français
(CA), français (FR), hrvatski,
italiano, latviesu, lietuviu,
magyar, nederlands,
norsk, polski, português,
русский, română,
slovenčina, slovenščina,
srpski, suomi, svenska,
türkçe, українська, čeština,
ελληνικά,

CVA 7845

Built-in coffee machine with DirectWater

Perfectly combinable design with CoffeeSelect + AutoDescale for highest demands.

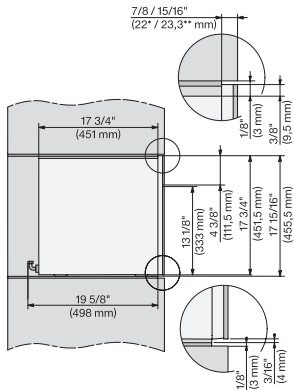

CVA7445, CVA7845, installation drawing, side view, 60 cm, Flush inset, NA

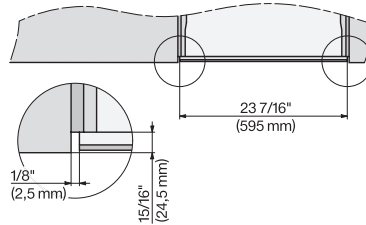

CVA7440, CVA7445, CVA7840, CVA7845, installation drawing, view from above, 60 cm, Flush inset

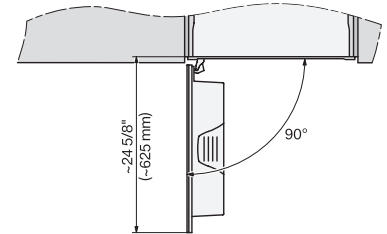

CVA7440, CVA7445, CVA7840, CVA7845, installation drawing, view from above, 60 cm, Flush inset

7/8" – 22* mm – Glass, 15/16" – 23.3** mm – Stainless steel

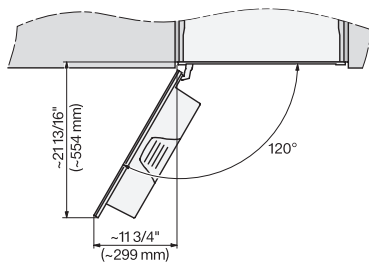

CVA7440, CVA7445, CVA7840, CVA7845, installation drawing, view from above, 60 cm, Flush inset

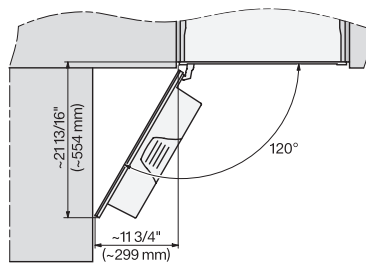

CVA7440, CVA7445, CVA7840, CVA7845, installation drawing, view from above, 60 cm, Flush inset

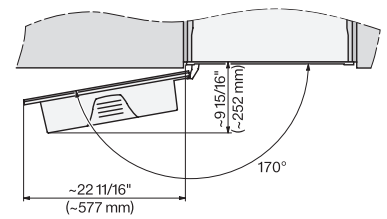

CVA7440, CVA7445, CVA7840, CVA7845, installation drawing, view from above, 60 cm, Flush inset

CVA 7845

Built-in coffee machine with DirectWater

Perfectly combinable design with CoffeeSelect + AutoDescale for highest demands.

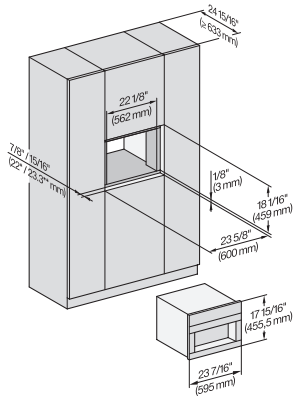

CVA7440, CVA7745, CVA7840, CVA7845, installation drawing, built in, 60 cm, Flush inset

7/8" – 22" mm – Glass, 15/16" – 23.3** mm – Stainless steel

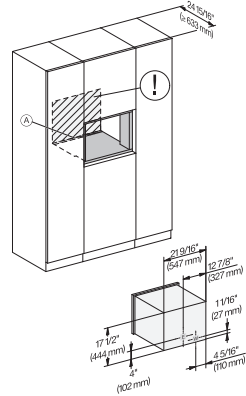

CVA7445, CVA7845, installation drawing, installation, 60 cm, Flush inset

A – Cut-out (1 1/2" x 20" / 38 mm x 508 mm) in the bottom of the cabinet for power cord and ventilation, – Electrical and water supplies are recommended to be placed in adjacent cabinetry., Additional cabinet depth is required when placing the electrical and water supplies behind the appliance., E = Electric connection, W = Water connection

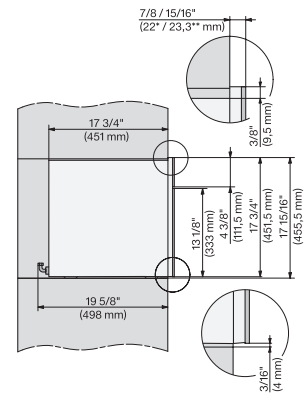

CVA7445, CVA7845, side view, 60 cm, Proud

7/8" – 22" mm – Glass, 15/16" – 23.3** mm – Stainless steel

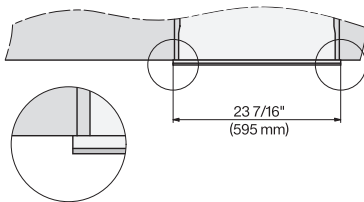

CVA7440, CVA7445, CVA7840, CVA7845, installation drawing, view from above, 60 cm, Proud

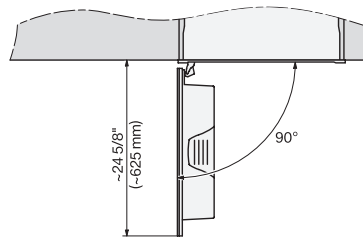

CVA7440, CVA7445, CVA7840, CVA7845, installation drawing, view from above, 60 cm, Proud

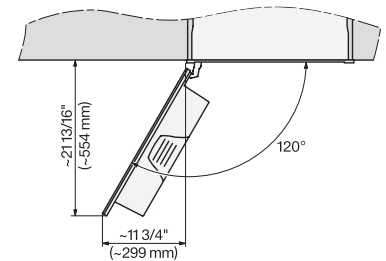

CVA7440, CVA7445, CVA7840, CVA7845, installation drawing, view from above, 60 cm, Proud

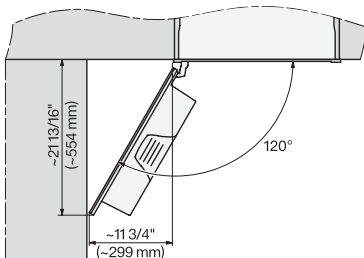

CVA7440, CVA7445, CVA7840, CVA7845, installation drawing, view from above, 60 cm, Proud

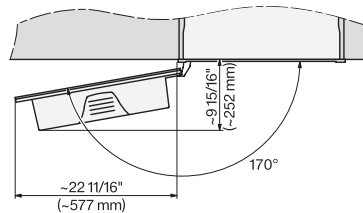

CVA7440, CVA7445, CVA7840, CVA7845, installation drawing, view from above, 60 cm, Proud

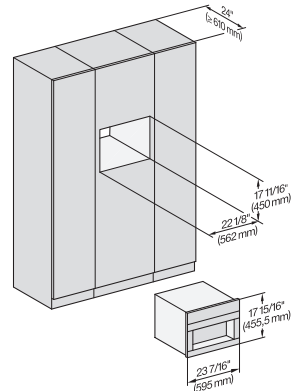

CVA7440, CVA7445, CVA7840, CVA7845, installation drawing, built in, Einbau, 60 cm, Proud

CVA 7845

Built-in coffee machine with DirectWater

Perfectly combinable design with CoffeeSelect + AutoDescale for highest demands.

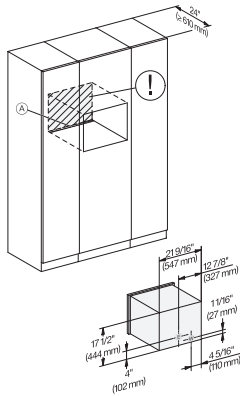

CVA7445, CVA7845, installation drawing, installation,
60 cm, Proud

A – Cut-out (1 1/2" x 20" / 38 mm x 508 mm) in the bottom of the cabinet for power cord and ventilation. – Electrical and water supplies are recommended to be placed in adjacent cabinetry. Additional cabinet depth is required when placing the electrical and water supplies behind the appliance. E = Electric connection, W = Water connection