

Luxury



Signature Series

HP24ZS - 24" Dual-Zone Freezer/Refrigerator Drawers

HP24ZO - 24" Outdoor Dual-Zone Freezer/Refrigerator Drawers



Indoor Models

- HP24ZS-5
- HP24ZS-6

Outdoor Models

- HP24ZO-5
- HP24ZO-6



Freezer/Refrigerator Drawers
HP24FS-5

General Signature Series Features

- Zero-clearance hinging allows for abutment with surrounding cabinetry
- Perlick's exclusive commercial-grade 1,000 Btu variable speed compressor
- Front-vented, RAPIDcool forced-air refrigeration system
- Commercial-grade stainless steel interior and exterior
- **Industry Exclusive** convertible door design allows all doors the ability to be converted to wood overlay from stainless steel
- **Industry Exclusive** adjustable, full-extension pull-out shelves (drawer models and beer dispensers excluded)
- Stainless-steel ball-bearing glides provide smooth movement of shelves
- Adjustable Crisp White and Cool Blue LED light options
- State-of-the-art digital control module
- Optional door locks and Industry-Exclusive drawer locks (factory installed)
- Stacking kit available
- Also available - 24" Refrigerator, Beverage Center, Wine Reserve, Beer Dispenser, dual-zone Refrigerator/Wine Reserve and dual-zone Wine Reserve.
- Indoor and Industry Exclusive outdoor models available
- 5.0 cubic feet of capacity
- Industry Best Three-Year Warranty plus additional three years on sealed system

Freezer Features

- Available with stainless steel drawers or wood overlay drawers
- Freezer equipped with automatic hot gas defrost for maintenance-free defrosting
- Includes two (2) full-extension pull-out drawers
- Freezer temperature -10°- 10°F (factory set at 0°F)
- Refrigerator temperature -30°- 42°F (factory set at 38°F)

Luxury YOU DESIRE

INNOVATION YOU CAN'T LIVE WITHOUT



8300 W. Good Hope Rd. • Milwaukee, WI 53223
1-800-558-5592 • Fax: (414) 353-7069 • perlick.com

Perlick is committed to continuous improvement. Therefore, we reserve the right to change specifications without warning.

Form No. HP24ZS
Rev. 01.14.2013

Product Specifications

Overall Width	23-7/8" (60.64 cm.)
Overall Height	34-1/4" (86.96 cm.)
Overall Depth	24" (60.96 cm.)
Opening Width	24" (60.96 cm.)
Opening Height	34-3/8" (87.31 cm.)
Opening Depth	24" (60.96 cm.)
Refrigerated Volume	5.0 cu. ft.
Drawer Clearance	18.25" (46.5 cm) minimum
Electrical	115V, 60Hz., 1 Phase, 2.3 amps
Plumbing	None Required
Annual Energy Usage	393 kWh/yr
Shipping Weight	191 lbs (68.04 kg)

Available Indoor Models - 24" Dual-Zone Freezer/Refrigerator Drawers

HP24ZS-5	Stainless steel drawers
HP24ZS-6	Wood overlay drawers

Available Outdoor Models - 24" Dual-Zone Freezer/Refrigerator Drawers

HP24ZO-5	Stainless steel drawers
HP24ZO-6	Wood overlay drawers

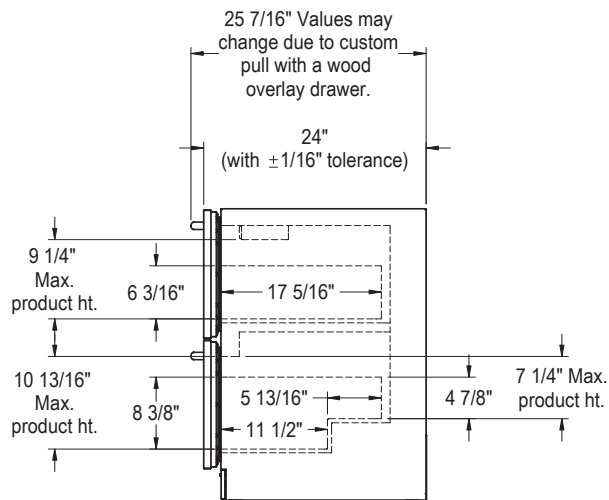
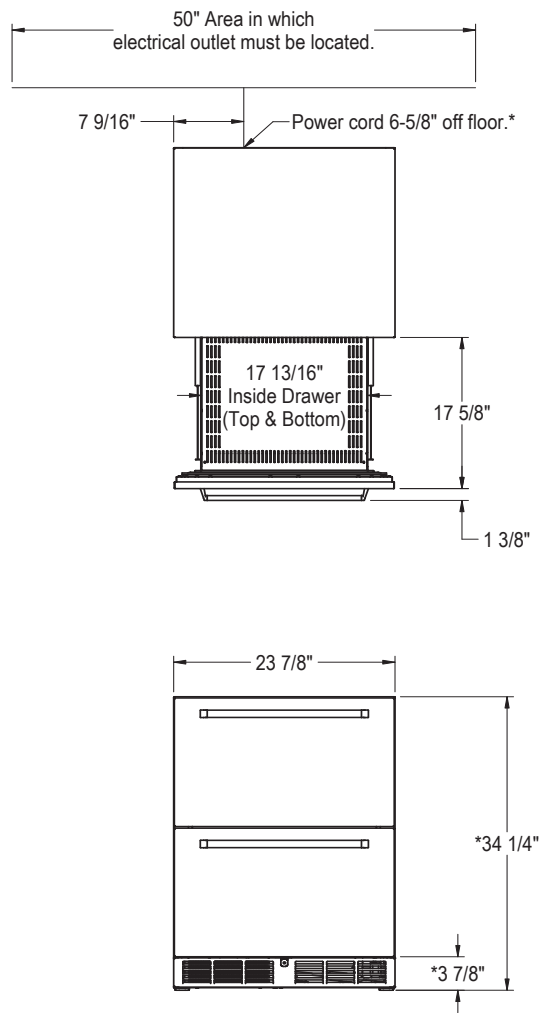

Form No.HP24ZS
Rev. 01.14.2013



8300 W. Good Hope Rd. • Milwaukee, WI 53223
1-800-558-5592 • Fax: (414) 353-7069 • perlick.com

Perlick is committed to continuous improvement. Therefore, we reserve the right to change specifications without warning.