

48" SIGNATURE SERIES FREEZER/REFRIGERATOR

HP48FR | 48" INDOOR MODEL

Perlick[®]
QUALITY & INNOVATION
THAT **INSPIRES**



Door/Door Model



Drawer/Drawer Model

GENERAL 48" SIGNATURE SERIES FEATURES

- Perlick's exclusive commercial-grade variable speed compressor
- Front-vented, RAPIDcool forced-air refrigeration system
- Commercial-grade stainless steel interior and exterior
- **Industry Exclusive** convertible door design allows all doors the ability to be converted to wood overlay from stainless steel
- **Industry Exclusive** adjustable, full-extension pull-out shelves (drawer models excluded)
- Stainless-steel ball-bearing glides provide smooth movement of shelves
- Low E, UV-coated glass provides industry leading insulation and protection.
- State-of-the-art digital control module
- Optional door locks and Industry-Exclusive drawer locks (factory installed)
- Stacking kit available
- Also available - 48" Refrigerator/Wine Reserve, Wine Reserve/Wine Reserve (one zone) and Wine Reserve/Wine Reserve (two zone)
- 11 cubic feet of capacity
- Industry Best Three Year Warranty plus additional three years on sealed system

HP48FR FEATURES

- Freezer compartment available with solid stainless steel door, wood overlay door, stainless steel drawers or wood overlay drawers
- Refrigerator compartment available with solid stainless steel door, wood overlay door, stainless steel glass door, wood overlay glass door, stainless steel drawers or wood overlay drawers
- Freezer equipped with automatic hot gas defrost for maintenance-free defrosting
- Compartments ordered with doors include two (2) full-extension pull-out shelves each
- Drawers are full-extension for easy stocking and access to goods
- Freezer drawer temperature -10° - 10°F (factory set at 0°F)
- Refrigerator drawer temperature 30°F - 42°F (factory set at 38°F)

Form No. HP48FR
Rev. 01.29.2014

PRODUCT SPECIFICATIONS

48" MODELS

Overall Width	47-7/8" (121.60 cm.)
Overall Height	34-1/4" (86.96 cm.)
Overall Depth	24" (60.96 cm.)
Opening Width	48" (121.92 cm.)
Opening Height	34-3/8" (87.31 cm.)
Opening Depth	24" (60.96 cm.)
Refrigerated Volume	11.0 cu. ft total (left compartment 5.0 cu. ft., right compartment 6.0 cu. ft.)
Door Swing Clearance	25" (63.50 cm.)
Drawer Clearance	18.25" (46.5 cm.) minimum
Electrical	115V, 60Hz., 1 Phase, 2.3 amps
Plumbing	None Required
Annual Energy Usage	448 kWh/yr
Shipping Weight	332 lbs (150.60 kg.)

HP48FR-S	48" Freezer/Refrigerator
----------	--------------------------

Freezer Door/Drawer Options

- 1 Solid stainless steel door, hinged left or right
- 2 Solid wood overlay door, hinged left or right
- 5 Stainless steel drawers
- 6 Wood overlay drawers

Refrigerator Door/Drawer Options

- 1 Solid stainless steel door, hinged left or right
- 2 Solid wood overlay door, hinged left or right
- 3 Stainless steel glass door
- 4 Wood overlay glass door
- 5 Stainless steel drawers
- 6 Wood overlay drawers

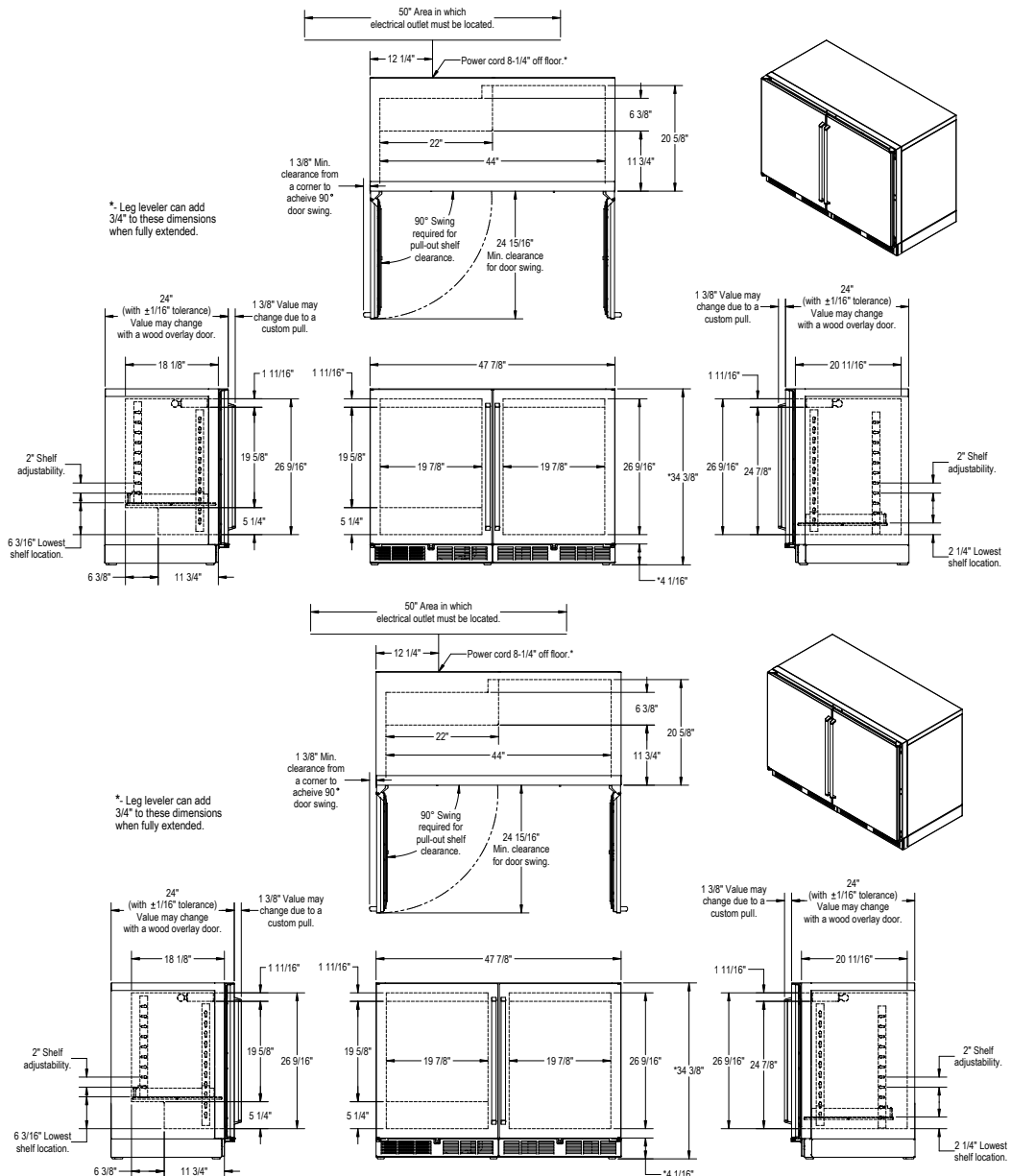

Form No. HP48FR
Rev. 01.29.2014