

FLUSH DISHWASHER

JDB9600CW – 23³/₁₆" x 34¹/₁₆" x 24⁹/₁₆"

PRODUCT DIMENSIONS

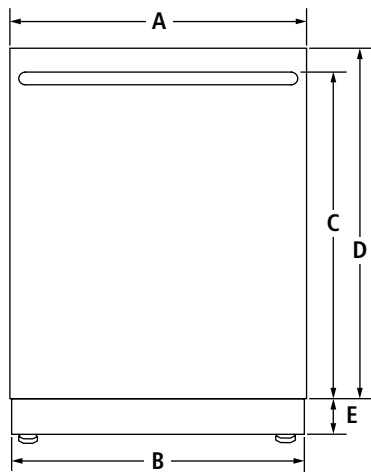

FRONT VIEW

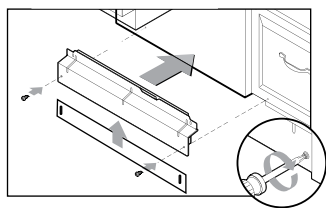

ADJUSTABLE TOE KICK

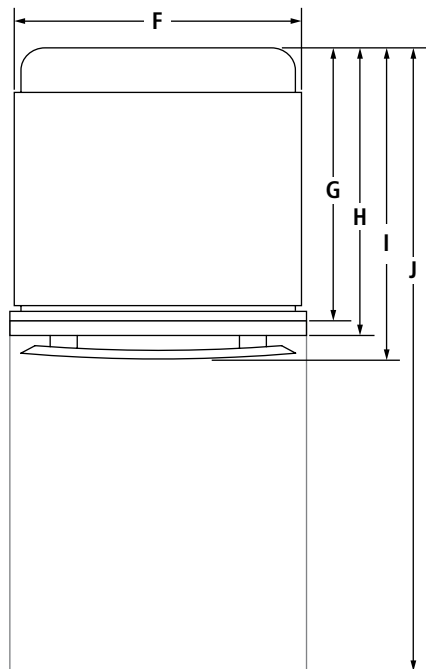

TOP VIEW

MODEL #		JDB9600CW	
		in	cm
A	Width of door	23 ³ / ₁₆	58.9
B	Width of toe kick	23 ¹ / ₂	59.7
C*	Height to top of handle	31 ³ / ₄	80.6
	Pro-Style® Stainless	31 ¹ / ₂	80.1
D	Height of door	30 ³ / ₁₆	76.6
	Pro-Style® Stainless	30 ³ / ₁₆	76.6
E	Height of adjustable toe kick (min.-max.)	4 ¹ / ₄ - 6 ¹ / ₈	10.8- 15.5
	Euro-Style Stainless	30 ³ / ₁₆	76.6
F	Width of recessed dishwasher	23 ³ / ₁₆	59.8
G	Depth with tub flange	20 ¹ / ₄	51.5
H	Depth with door		
	Pro-Style® Stainless	22 ⁷ / ₁₆	57.0
I*	Euro-Style Stainless	22 ⁷ / ₁₆	57.0
	Depth with handle		
J	Pro-Style® Stainless	25 ¹ / ₁₆	63.6
	Euro-Style Stainless	24 ⁹ / ₁₆	62.4
J	Depth with door fully open	47 ⁷ / ₁₆	120.5

IMPORTANT: Dimensional specifications are provided for planning purposes only.

Do not make any cutouts based on this information. Refer to the Installation or Use & Care Guide before selecting cabinetry, verifying electrical/gas connections, making cutouts or beginning installation. All Jenn-Air® appliances are appropriately UL, CUL or CSA approved.

FLUSH DISHWASHER

JDB9600CW – 23⁹/₁₆" x 34¹/₁₆" x 24⁹/₁₆"

DIMENSIONS AS INSTALLED

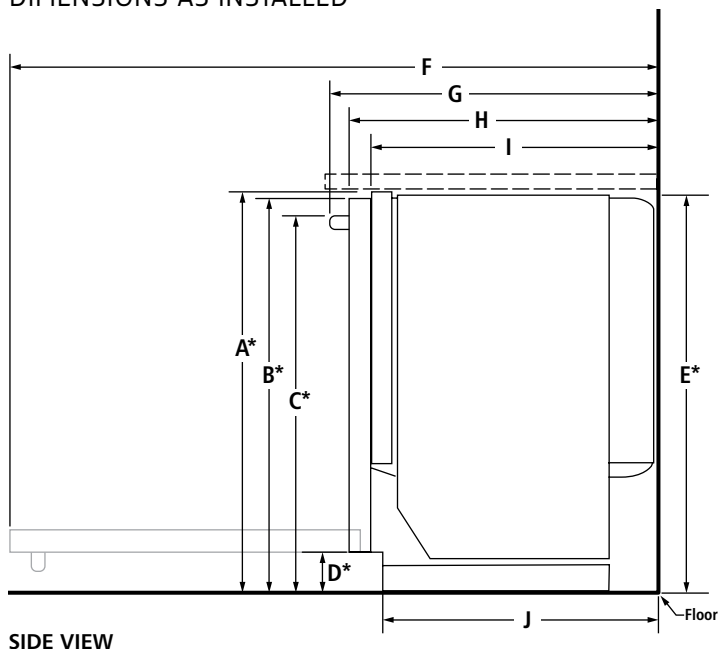

SIDE VIEW

MODEL #		JDB9600CW	
		in	cm
A*	Height to top of tub flange (min.)	34 ¹ / ₁₆	86.5
B*	Height to top of door (min.)	33 ¹⁵ / ₁₆	86.2
C*	Height to top of handle (min.)		
	Pro-Style® Stainless	31 ³ / ₄	80.6
	Euro-Style Stainless	31 ¹ / ₂	80.1
D*	Height to bottom of door	3 ⁵ / ₈	9.4
E*	Height of recessed dishwasher (min.)	34 ¹ / ₁₆	86.5
F	Depth with door fully open (min.)	47 ⁷ / ₁₆	120.5
	Depth with handle (min.)		
G	Pro-Style® Stainless	25 ¹ / ₁₆	63.6
	Euro-Style Stainless	24 ⁹ / ₁₆	62.4
H	Depth with door (min.)	22 ⁷ / ₁₆	57.0
I	Depth with tub flange (min.)	20 ¹ / ₄	51.5
J	Depth with toe kick (min.)	17 ¹⁵ / ₁₆	45.5

*Add up to 2³/₈" (6 cm) in height with leg levelers fully extended.

IMPORTANT: Dimensional specifications are provided for planning purposes only. Do not make any cutouts based on this information. Refer to the Installation or Use & Care Guide before selecting cabinetry, verifying electrical/gas connections, making cutouts or beginning installation. All Jenn-Air® appliances are appropriately UL, CUL or CSA approved.



FLUSH DISHWASHER

JDB9600CW – 23⁹/₁₆" x 34¹/₁₆" x 24⁹/₁₆"

OPENING/CLEARANCE DIMENSIONS

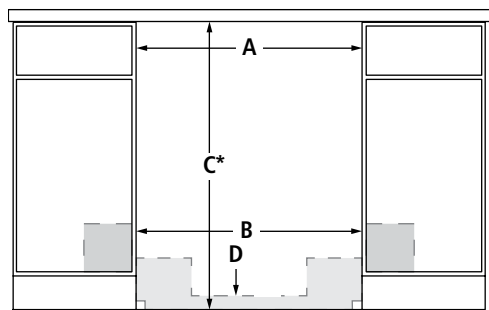

FRONT VIEW

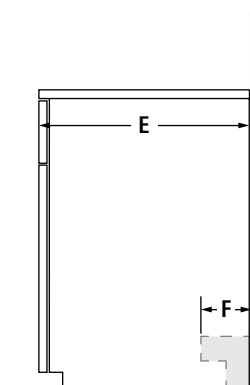

SIDE VIEW

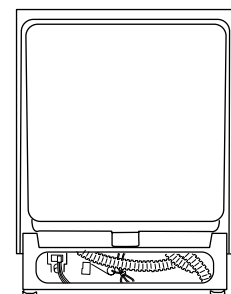

BACK VIEW

MODEL #		JDB9600CW	
		in	cm
A	Width (min.)	24	61.0
B	Width of clear area (back wall)	24	61.0
C*	Height	34 ¹ / ₁₆	86.5
D	Height of possible utility installation area (back wall)	3 ¹ / ₂	8.9
E	Depth (min.)	24	61.0
F	Depth of utility location (side wall)	2 ¹ / ₁₆	5.3

Water and drain connections may be installed in lighter shaded areas

Recommended drain connection location – closest to sink	1 ¹ / ₂ dia. 3.8 dia.
Recommended water connection location – left-hand side or back wall	1/2 dia. 1.3 dia.

Electrical connections may be installed in darker shaded areas

Recommended electrical connection location – adjacent cabinet	1 ¹ / ₂ dia. 3.8 dia.
---	---

*Measured from the lowest point on the underside of countertop.

ELECTRICAL REQUIREMENTS

120 volt, 60 Hz, AC only, 15- or 20-amp fused, grounded circuit is required. A dedicated circuit is recommended. Use an outlet that cannot be turned off by a switch. Do not use an extension cord.

WATER SUPPLY REQUIREMENTS

120°F (49°C) hot water supply with water pressure between 15 and 145 psi (103 and 1,000 kPa) is required. If you have questions about your water pressure, call a licensed, qualified plumber.

DRAIN REQUIREMENTS

Connect drain hose to waste tee or disposer inlet above drain trap. Maximum drain hose length 12¹/₂' (3.8 m).

LOCATION REQUIREMENTS

Corner locations require a 2" (5.1 cm) minimum clearance between the side of the dishwasher door and the wall or cabinet.

IMPORTANT: Dimensional specifications are provided for planning purposes only. Do not make any cutouts based on this information. Refer to the Installation or Use & Care Guide before selecting cabinetry, verifying electrical/gas connections, making cutouts or beginning installation. All Jenn-Air® appliances are appropriately UL, CUL or CSA approved.